



Dorchester Close Cliffe Woods ME3 8JB

Freehold



Council Tax: B
EPC Rating: E

This one bedroom freehold house is being offered to the market with no onward chain. Benefitting from driveway, conservatory and close to local amenities and motorway links.

- No chain
- Freehold
- Village location
- Close to amenities
- Conservatory

Offers Over £190,000

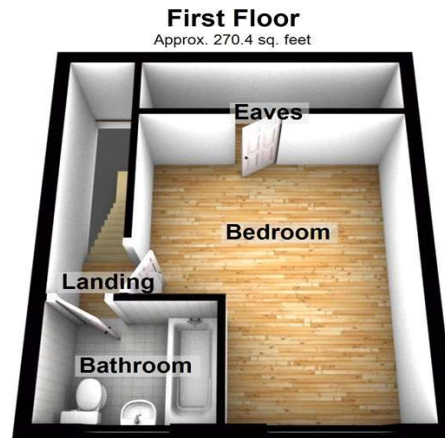
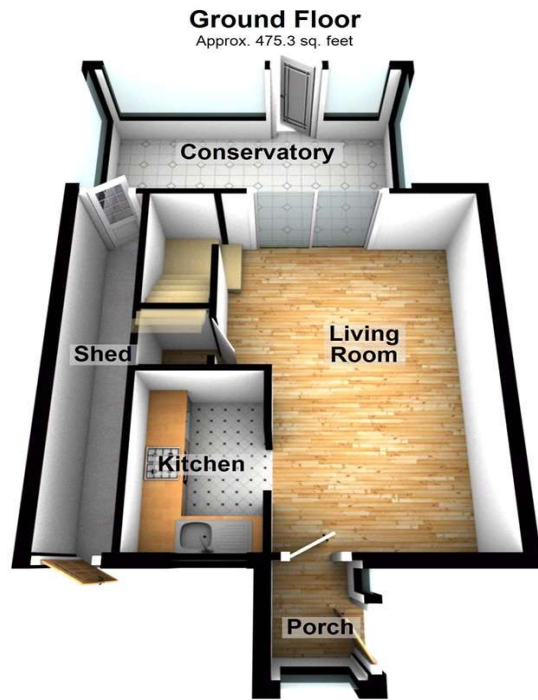

Total area: approx. 745.7 sq. feet

Please be advised this plan is offered for marketing purposes only. It can not be relied upon for exact or precise measurements, angles, window or door openings. Whilst every effort is made to ensure the accuracy the company or provider accepts no responsibility for the content.

Plan produced using PlanUp.

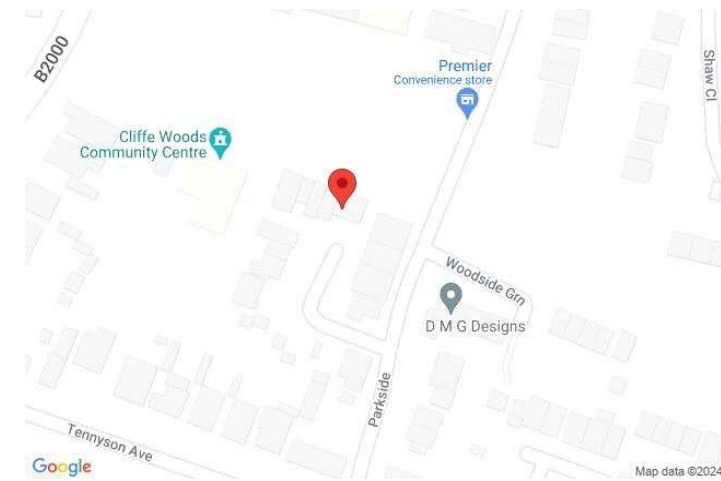

**FOR MORE INFORMATION
CONTACT US TODAY.**

01634 722777

Robinson Michael & Jackson
109 High Street
Strood,
Kent ME2 4TJ

strood@robinson-jackson.com



Interior

Porch 1.6m x 1.07m (5'3" x 3'6") Carpet.

Lounge 5.7m x 3.7m (18'8" x 12'2") Carpet, double glazed window to front, double glazed patio door to rear.

Conservatory 2.64m x 4.62m (8'8" x 15'2") Laminate flooring, double glazed door to rear, storage heating.

Kitchen 1.65m x 2.67m (5'5" x 8'9") Carpet, double glazed window to front, space for appliances, oven extractor fan over, sink drainer with mixer tap.

Bedroom One 3.7m x 4.11m (12'2" x 13'6") Carpet, double glazed window to front.

Bathroom 1.65m x 2.18m (5'5" x 7'2") Carpet, panelled bath, sink basin, low level w/c, double glazed window to front.

Additional Information

A stunning but underrated village in north Kent has proved to be the number one spot for buyers this year. Cliffe Woods is a village on the Hoo Peninsula in Medway, built in an ancient area of woodland. It has been declared as the number one spot in Kent for buyer searches, according to Rightmove. Cliffe woods is a village which is situated closely to Cliffe and only a 5 minute drive to local Motorway links. The local parish is Cliffe and Cliffe woods Parish council.