



Dean Road | Sittingbourne, Kent, ME10 2DG



Asking Price £325,000 Freehold

ROBINSON MICHAEL & JACKSON
Our service will *move* you

Dean Road, Sittingbourne

Situated in Milton, this end-of-terrace property offers practicality and comfort across its three-bedroom layout. The exterior presents a well-maintained facade with a sizeable driveway leading to a large garage, ensuring ample parking space. The end-of-terrace location adds a layer of privacy to the property, enhancing its appeal as a quiet retreat.

Upon entry, a functional lounge sets the tone for the home, providing a space for relaxation or social gatherings. Moving through the ground floor, a spacious kitchen diner with modern amenities caters to everyday living and entertaining needs. The kitchen's layout combines practicality with contemporary design elements, creating a pleasing aesthetic.

Ascending to the first floor, three well-proportioned bedrooms offer comfortable accommodations. Each bedroom features neutral decor and sufficient natural light, accommodating various furniture arrangements. A well-appointed bathroom with modern fixtures completes the upper level, offering convenience for residents.

The property's rear garden is a highlight, showcasing meticulous landscaping and a large summer house. The outdoor space provides a serene environment for relaxation or outdoor activities, complementing the indoor living spaces. Overall, this 3-bedroom end-of-terrace in Milton offers a blend of functionality, convenience, and outdoor charm, ideal for modern living.



Property Features

- Council Tax: B
- EPC Rating: C
- Three bedroom end of terrace
- No chain
- Open plan kitchen/diner
- Popular location
- Large garage & driveway
- Potential to extend (STPP)

Interior

Entrance Hall:

Lounge: 4.27m x 3.53m (14' x 11'7")

Kitchen/Breakfast Room: 6.2m x 3.6m (20'4" x 11'10")

Bedroom 1: 4.32m x 3m (14'2" x 9'10")

Bedroom 2: 4.06m x 1.9m (13'4" x 6'3")

Bedroom 3: 3.4m x 2.24m (11'2" x 7'4")

Bathroom:

Exterior

Garage with driveway

Rear garden featuring a summer house, South facing garden.

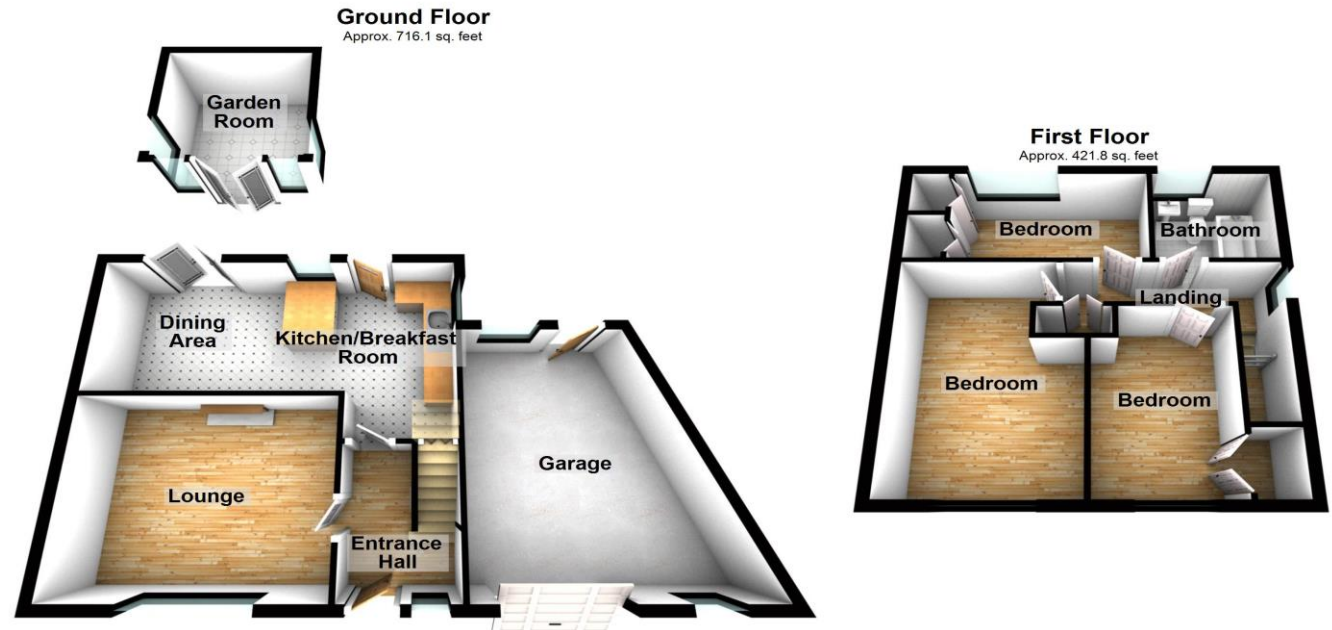

Total area: approx. 1137.9 sq. feet

Please be advised this plan is offered for marketing purposes only. It can not be relied upon for exact or precise measurements, angles, window or door openings. Whilst every effort is made to ensure the accuracy the company or provider accepts no responsibility for the content.
Plan produced using PlanUp.





Property Location

Dean Road, Sittingbourne, Kent, ME10 2DG

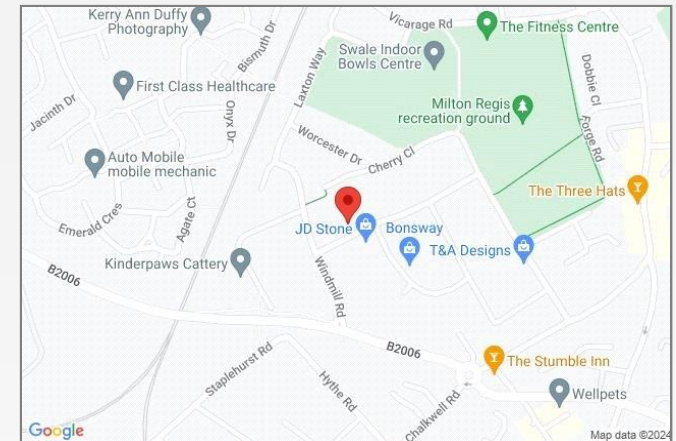

**FOR MORE INFORMATION
CONTACT US TODAY.**

01795 479999
Robinson Michael & Jackson
38 West Street,
Sittingbourne,
Kent, ME10 1AP
sittingbourne@robinson-jackson.com

