



Rhodewood Close | Downswood, Maidstone, ME15 8UR



Guide Price £325,000 - £350,000

Freehold

**ROBINSON MICHAEL & JACKSON**

Our service will *move* you

## Rhodewood Close, Downswood

This charming semi-detached residence is strategically positioned within a desirable cul-de-sac, nestled on the outskirts of a vibrant residential community bordering the scenic Len Valley.

### Property Features

- Council Tax: D
- EPC Rating: C
- Flat generous size rear garden
- Off street parking
- No onward chain
- Three bedrooms



## Interior

**Entrance Hall** Entrance door, meter cupboard

**Lounge** 4.32m x 3.96m (14'2" x 13') Staircase to first floor, window to front, radiator

**Dining Room** 3.18m x 2.24m (10'5" x 7'4") Double radiator, double doors leading into the garden

**Kitchen** 3.18m x 1.83m (10'5" x 6') Window to the rear, built in oven & hob

**Bedroom 1** 3.66m x 2.62m (12' x 8'7") Window to front, radiator, double built-in wardrobe cupboard with mirrored sliding doors, double bedroom

**Bedroom 2** 2.9m x 2.13m (9'6" x 7') Window to rear, radiator, double bedroom

**Bedroom 3** 2.26m x 2.03m (7'5" x 6'8") Radiator, window to rear

**Bathroom** Shower over bath, basin & WC

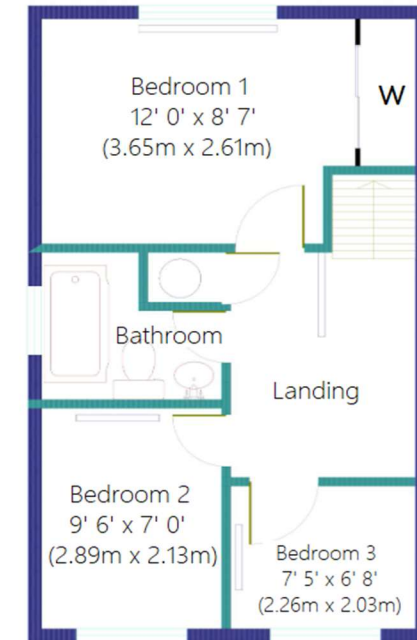
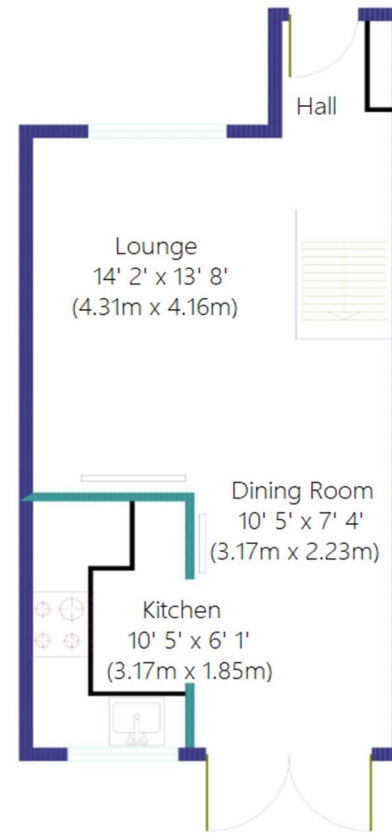



## Property Location

Rhodewood Close, Downswood, Maidstone, ME15 8UR

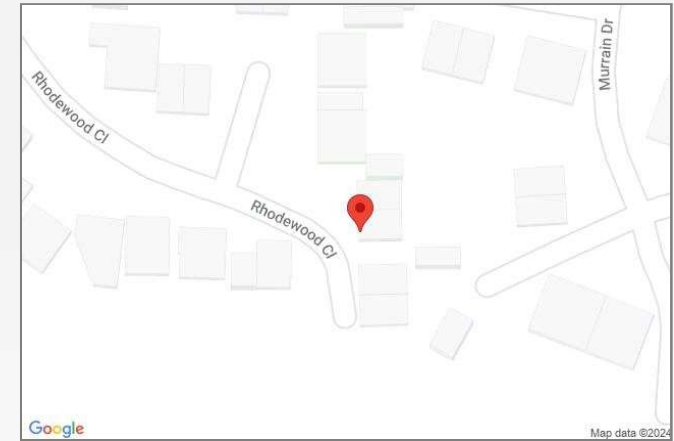

 **Scan for the latest properties...**

 Follow us on **facebook** for early access to new properties for sale.



**FOR MORE INFORMATION  
CONTACT US TODAY.**

01622 476666  
Robinson Michael & Jackson  
15A King Street  
Maidstone,  
Kent ME14 1BA  
maidstone@robinson-jackson.com

