



Charles Street | Greenhithe, Kent, DA9 9AN



Guide Price: £325,000 to £350,000

Freehold

**ROBINSON-JACKSON**  
Our service will *move* you



# Charles Street, Greenhithe

Robinson-Jackson are delighted to present this beautiful 2-bedroom terraced home to the market on Charles Street in Greenhithe.

On entrance the home is well-presented and ready to move straight into. With unique features the property needs to be at the top of your viewing list. The ground floor consists of an open plan lounge/dining area, kitchen (with storage) and bathroom.

The first floor comprises of 2 double bedrooms.

Externally you will find a garden (with patio area) and large garage to the rear perfect for a home gym, parking or office. This is truly a MUST SEE home and internal viewing is essential to fully appreciate everything this property has to offer. Please contact Robinson-Jackson today to book your viewing.

With its prime location close to Greenhithe Station, Stone Crossing train station and the popular Bluewater shopping destination, this home offers a truly desirable lifestyle.

## Property Features

- Close To Greenhithe Station
- Generous Garage
- Investment
- Open Plan
- Garden & Patio
- Close To Bluewater





## Interior

**Lounge/Dining:** 6.22m x 3.35m (20'5" x 11') Double glazed window to front. Two vertical radiators. Stairs to first floor. Wood flooring.

**Kitchen:** 3.45m x 3.28m (11'4" x 10'9") Double glazed window to rear. Double glazed door leading to rear garden. Range of matching wall and base units with complimentary work surface over. Sink with drainer. Integrated electric oven, hob and extractor. Integrated microwave. Integrated fridge freezer. Space and plumbing for washing machine. Part tiled walls. Tiled flooring. Part glass roof.

**Bathroom:** Double glazed frosted window to rear. Low level WC. Bidet. Vanity wash hand basin. Panelled bath with fitted shower and shower screen. Vertical radiator. Part tiled walls. Tiled flooring.

**Bedroom One:** 3.38m x 2.97m (11'1" x 9'9") Double glazed window to front. Radiator. Wood flooring.

**Bedroom Two:** 3.15m x 2.44m (10'4" x 8') Double glazed window to rear. Radiator. Wood flooring.

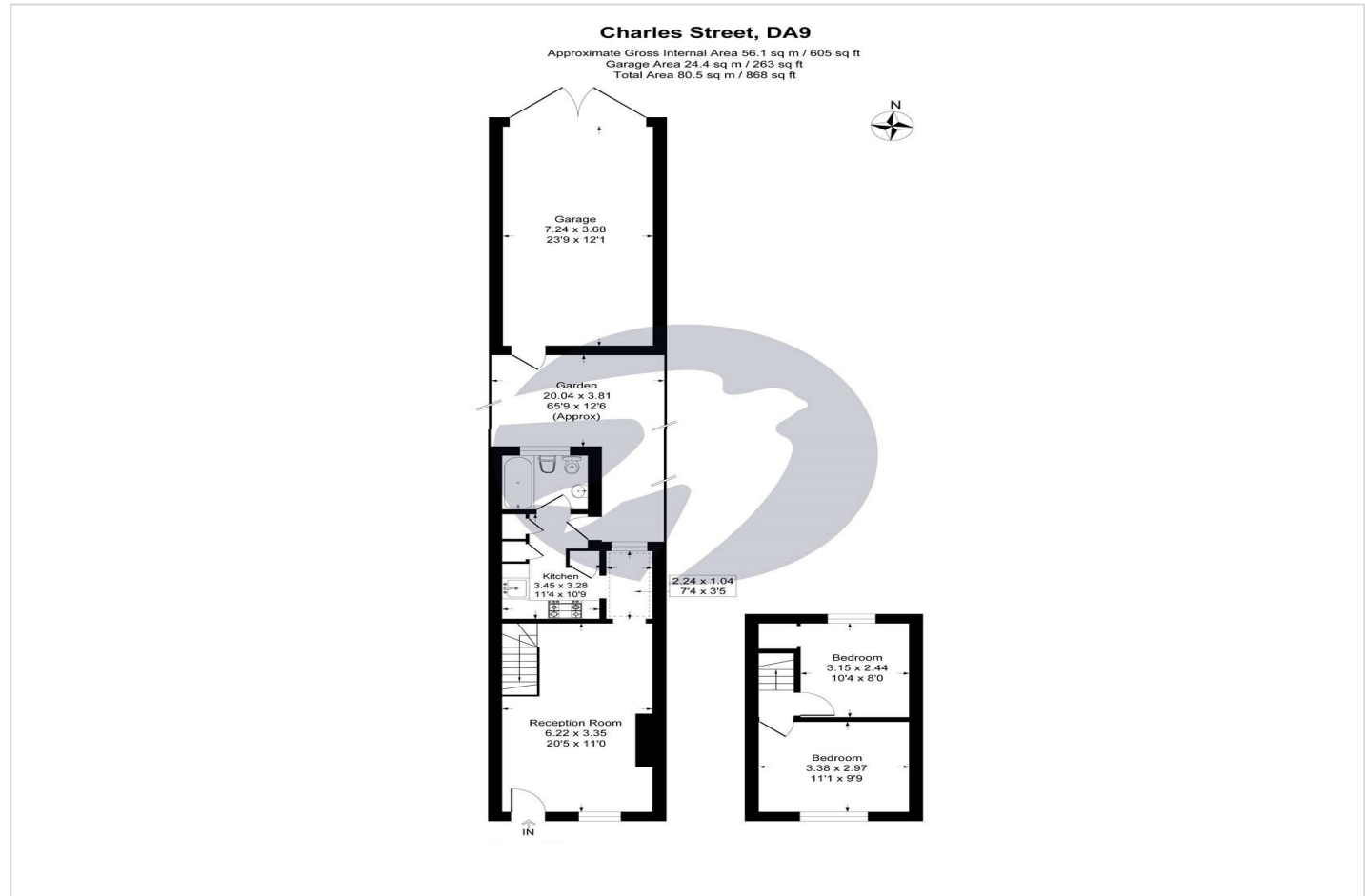





## Property Location

Charles Street, Greenhithe, Kent, DA9 9AN

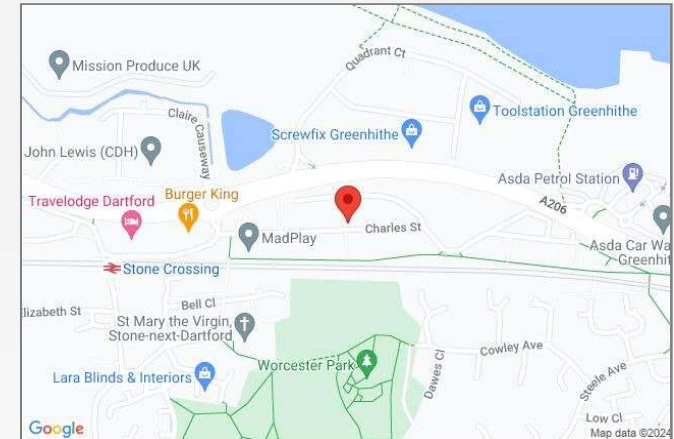

## Exterior

Rear Garden: Approximately 66ft. Mainly laid to lawn. Patio area.

Undercover seating area.

Garage: 23'9 x 12'1

## Additional Information

Dartford Borough Council - Tax Band B

Total floor area: 52 sq. metres

FOR MORE INFORMATION  
CONTACT US TODAY.

01322 624440

Robinson Jackson  
39 High Street,  
Swanscombe  
Kent,  
DA10 0AG

swanscombe@robinson-jackson.com

