



Croydon Close | Lordswood, Kent, ME5 8RT



Offers in excess of £240,000 Freehold

**ROBINSON MICHAEL & JACKSON**  
Our service will *move* you

# Croydon Close, Lordswood

CALLING ALL FIRST TIME BUYERS!

A two bedroom house with a garage and parking space to the rear.

## Property Features

- Council Tax: B
- EPC Rating: C
- Two bedroom terraced
- Potential drive way to front
- Garage En bloc
- Popular location
- Ideal first time buyers home
- Great investors opportunity



## Interior

Front Door To:

Entrance Hall:

Kitchen/Diner: 3.58m x 2.36m (11'9" x 7'9")

Lounge: 3.35m x 2.97m (11' x 9'9")

First Floor Landing:

Bedroom 1: 3.35m x 3.12m (11' x 10'3")

Bedroom 2: 3.33m x 1.68m (10'11" x 5'6")

Bathroom: 2.7m x 1.45m (8'10" x 4'9")

## Exterior

Rear Garden: Patio area, mainly laid to lawn.

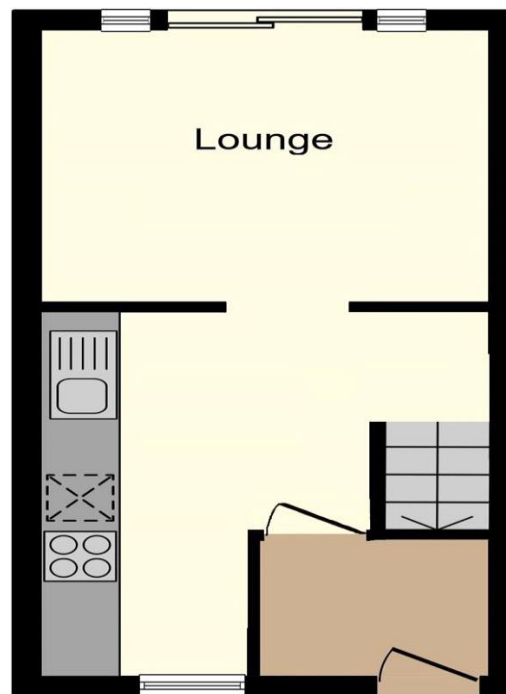

Ground Floor

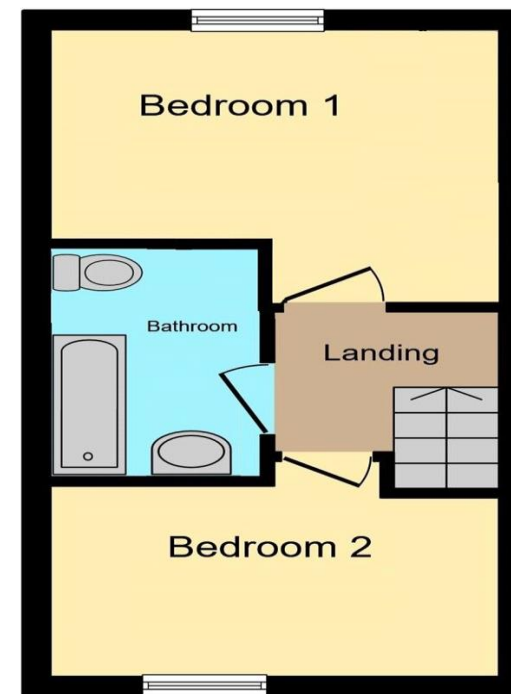

First Floor





## Property Location

Croydon Close, Lordswood, Kent, ME5 8RT

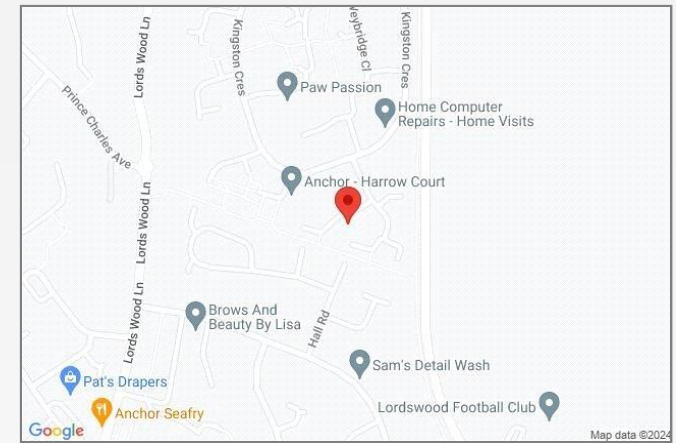

\*All distances from the ME5 8EH postcode . Train time from Maidstone East station.

**FOR MORE INFORMATION  
CONTACT US TODAY.**

01634 868000

Robinson Michael & Jackson  
381 Walderslade Road,  
Walderslade,  
Kent ME5 9LL

walderslade@robinson-jackson.com

