



Colney Road | Dartford, Kent, DA1 1TG



Asking Price £450,000

Freehold

ROBINSON-JACKSON
Our service will *move* you

Colney Road, Dartford

Robinson Jackson are delighted to offer for sale this extended four bedroom home located on a tree lined road on the East side of Dartford. The property also benefits from a South facing rear garden.

Property Features

- Council Tax: C
- EPC Rating: D
- 125ft Private South Facing Rear Garden
- Two Reception Rooms
- Off Street Parking
- Ideally Located For East Dartford's Popular Schools
- 0.7 Miles Walk To Dartford Station And Town Centre
- Viewing Comes Highly Recommended



Interior

Entrance Hall: Hardwood glazed entrance door. Wood effect laminate flooring. Carpeted stairs to first floor.

Living Room: Double glazed bay window to front. Ceiling rose. Picture rail. Radiator. Feature fireplace with gas fire inset. Wood effect laminate flooring.

Dining Room: Double glazed window to rear. Frosted double glazed window to side. Coved ceiling. Dado rail. Radiator. Wood effect flooring. Under stairs storage cupboard housing electric and gas meters.

Kitchen: Double glazed window to side. Door to conservatory. Matching range of wall and base units. Complimentary work-surfaces. Under cabinet lighting. Tiled splash backs. Space for American fridge freezer. Stainless steel four ring gas hob with cooker hood above. Plumbing for washing machine. Built in dishwasher. Bin storage. Cupboard housing combi boiler. One and a half bowl sink unit. Wood effect laminate flooring.

Conservatory: Double glazed door to garden. Double glazed window to side. Tiled floor with u set floor heating.

Landing: Wood effect flooring. Radiator. Stairs to second floor.

Bedroom Two: Two double glazed windows to front. Feature fireplace. Radiator. Wood effect flooring.

Bathroom: Frosted double glazed window to side. Coved ceiling. Pedestal wash hand basin. Panel bath. Low level WC. Part tiled walls. Heated towel rail. Wood effect flooring.

Bedroom One: Double glazed window to rear. Access to loft housing water tank. Range of built in wardrobes. Wood effect flooring. Dado rail.

Bedroom Four: Double glazed window to rear. Radiator. Wood effect flooring.

Bedroom Three Second Floor: Velux window to rear. Velux window to front. Eaves storage. Electric heater. Wood effect flooring.

Ground Floor
Approx. 47.1 sq. metres (506.9 sq. feet)

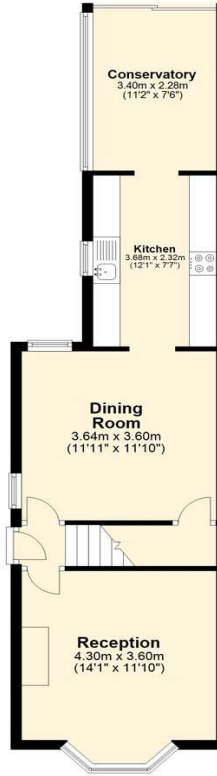

First Floor
Approx. 38.6 sq. metres (415.8 sq. feet)



Second Floor
Approx. 14.7 sq. metres (158.6 sq. feet)

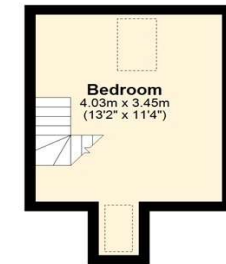

Total area: approx. 100.4 sq. metres (1081.2 sq. feet)





Property Location

Colney Road, Dartford, Kent, DA1 1TG

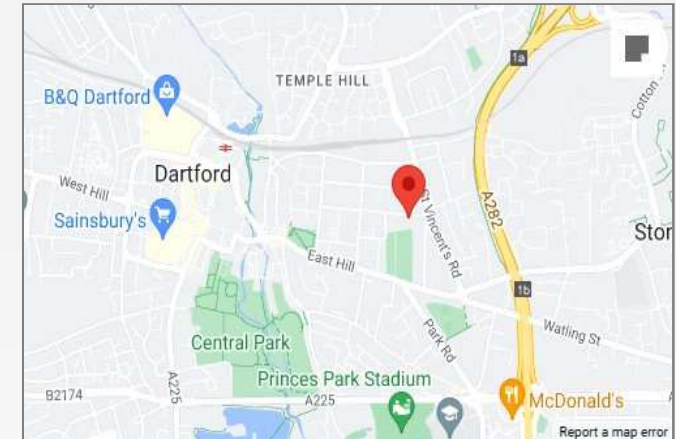

*All distances from branch postcode. Train time from nearest station.

Exterior

Front Garden: Hard standing providing off street parking car.

Rear Garden: 125ft. South facing. Side pedestrian access. Outside tap.
Patio area. Mainly laid to lawn with shrub and tree borders. Shed.

Parking: Off street parking to front.

Additional Information

Council Tax - Dartford Band C

The garden is South facing.

The property has off street parking.

The owners are looking for a property.

The boiler is located in the kitchen.

**FOR MORE INFORMATION
CONTACT US TODAY.**

01322 281281

Robinson Jackson
22 Market Street,
Dartford,
Kent DA1 1EZ

dartford@robinson-jackson.com



These particulars do not form part of an offer or contract and must not be relied upon as statements or representation of fact. Any areas, measurements, journey times or distances are approximate. The text, images, photographs and plans are for guidance only and are not necessarily comprehensive. It should not be assumed that the property has all necessary planning, building regulation or other consents and we have not tested any services, equipment or facilities. References to tenure are based on information supplied by the seller. Buyer should verify all information themselves by inspection or otherwise prior to a legal commitment to purchase. Photos and images are subject to copyright.