



Colney Road | Dartford, Kent, DA1 1TG



£425,000 to £450,000

Freehold

ROBINSON-JACKSON
Our service will *move* you

Colney Road, Dartford

Robinson Jackson are delighted to offer for sale this extended four bedroom home located on a tree lined road on the East side of Dartford. The property also benefits from a South facing rear garden.

Property Features

- Council Tax: C
- EPC Rating: D
- 125ft Private South Facing Rear Garden
- Two Reception Rooms
- Off Street Parking
- Ideally Located For East Dartford's Popular Schools
- 0.7 Miles Walk To Dartford Station And Town Centre



Interior

Entrance Hall: Hardwood glazed entrance door. Wood effect laminate flooring. Carpeted stairs to first floor.

Living Room: Double glazed bay window to front. Ceiling rose. Picture rail. Radiator. Feature fireplace with gas fire inset. Wood effect laminate flooring.

Dining Room: Double glazed window to rear. Frosted double glazed window to side. Coved ceiling. Dado rail. Radiator. Wood effect flooring. Under stairs storage cupboard housing electric and gas meters.

Kitchen: Double glazed window to side. Door to conservatory. Matching range of wall and base units. Complimentary work-surfaces. Under cabinet lighting. Tiled splash backs. Space for American fridge freezer. Stainless steel four ring gas hob with cooker hood above. Plumbing for washing machine. Built in dishwasher. Bin storage. Cupboard housing combi boiler. One and a half bowl sink unit. Wood effect laminate flooring.

Conservatory: Double glazed door to garden. Double glazed window to side. Tiled floor with u set floor heating.

Landing: Wood effect flooring. Radiator. Stairs to second floor.

Bedroom Two: Two double glazed windows to front. Feature fireplace. Radiator. Wood effect flooring.

Bathroom: Frosted double glazed window to side. Coved ceiling. Pedestal wash hand basin. Panel bath. Low level WC. Part tiled walls. Heated towel rail. Wood effect flooring.

Bedroom One: Double glazed window to rear. Access to loft housing water tank. Range of built in wardrobes. Wood effect flooring. Dado rail.

Bedroom Four: Double glazed window to rear. Radiator. Wood effect flooring.

Bedroom Three Second Floor: Velux window to rear. Velux window to front. Eaves storage. Electric heater. Wood effect flooring.

Ground Floor
Approx. 47.1 sq. metres (506.9 sq. feet)

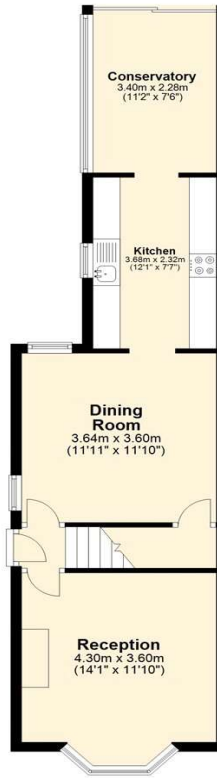

First Floor
Approx. 38.6 sq. metres (415.8 sq. feet)



Second Floor
Approx. 14.7 sq. metres (158.6 sq. feet)

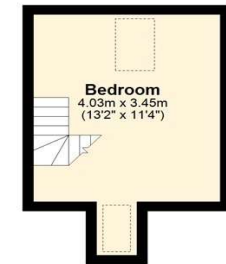

Total area: approx. 100.4 sq. metres (1081.2 sq. feet)

Exterior

Front Garden: Hard standing providing off street parking car.

Rear Garden: 125ft South facing. Side pedestrian access. Outside tap.

Patio area: Mainly laid to lawn with shrub and tree borders. Shed.

Parking: On street parking to front.

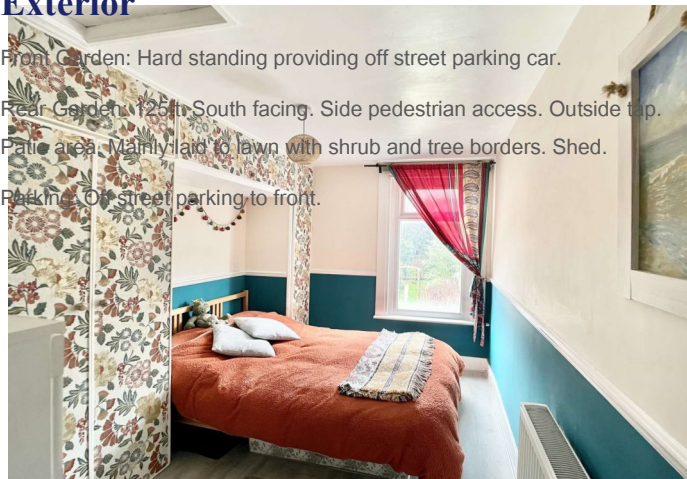



Property Location

Colney Road, Dartford, Kent, DA1 1TG

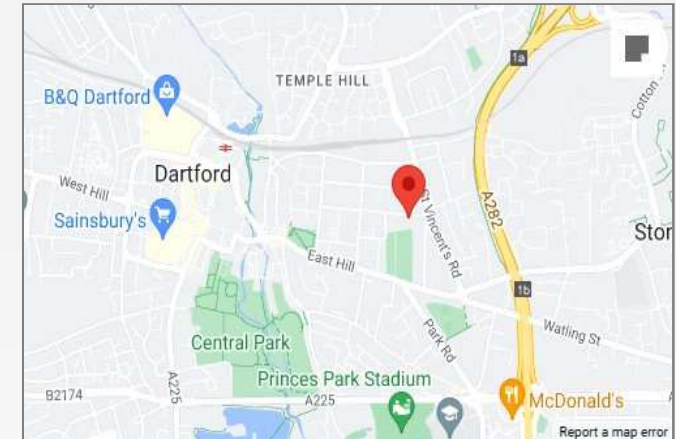

*All distances from branch postcode. Train time from nearest station.

Additional Information

Council Tax - Dartford Band C

The garden is South facing.

The property has off street parking.

The owners are looking for a property.

The boiler is located in the kitchen.

Please note the rear garden backs onto a graveyard.

**FOR MORE INFORMATION
CONTACT US TODAY.**

01322 281281

Robinson Jackson
22 Market Street,
Dartford,
Kent DA1 1EZ

dartford@robinson-jackson.com

