



Cooper Close | DA9 9PN



Asking Price: £190,000

Leasehold

ROBINSON-JACKSON
Our service will *move* you

Cooper Close,

Robinson Jackson are delighted to present this ground floor maisonette offering contemporary living in a convenient location.

This property features a spacious open plan living area, a fully equipped separate kitchen, one bedroom and a stylish bathroom.

With a parking space directly outside your front door this property offers convenience and peace of mind. Situated within walking distance of Stone Crossing Station, commuting is made easy for residents. This property is ideal for first-time buyers, professionals, or investors looking for a well-maintained and conveniently located home. Don't miss out on this opportunity to own a modern maisonette in a sought-after location.

Property Features

- Council Tax: C
- EPC Rating: D
- Ground Floor Maisonette
- New Kitchen (2022)
- New Electric Heaters (2021)
- Allocated Parking Directly Outside
- Communal Garden



Interior

Lounge/Dining: 6.55m (21'6") x 4.75m (15'7") x 3.53m (11'7")
Double glazed window to front. Electric fireplace. Understairs storage cupboard. Laminate flooring.

Kitchen: 2.7m x 1.65m (8'10" x 5'5") Double glazed window to rear. Range of matching wall and base units with complimentary work surface over. Sink with drainer. Integrated electric oven, hob and extractor. Space for fridge freezer. Space and plumbing for washing machine. Part tiled walls. Laminate flooring.

Bedroom One: 2.95m (9'8") x 2.92m (9'7") (to wardrobes)
Double glazed window. Built in wardrobe. Wall mounted electric heater. Laminate flooring.

Bathroom: 2m x 1.65m (6'7" x 5'5") Low level WC. Vanity wash hand basin. Panelled bath with fitted shower and shower screen. Heated towel rail. Tiled walls and flooring. Extractor fan.

Exterior

Allocated parking bay directly outside.

Communal garden.

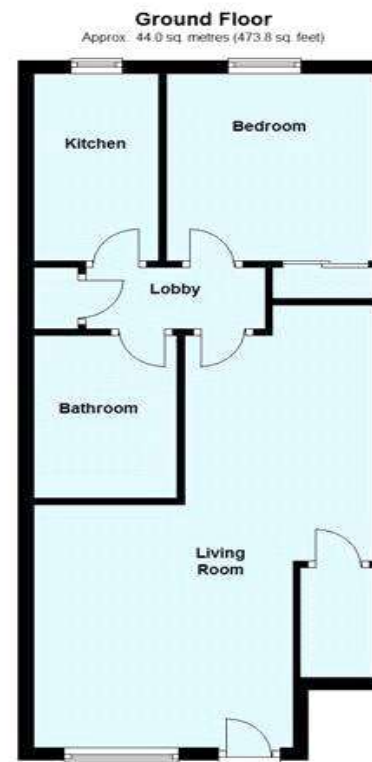

Total area: approx. 44.0 sq. metres (473.8 sq. feet)





Property Location

Cooper Close, DA9 9PN

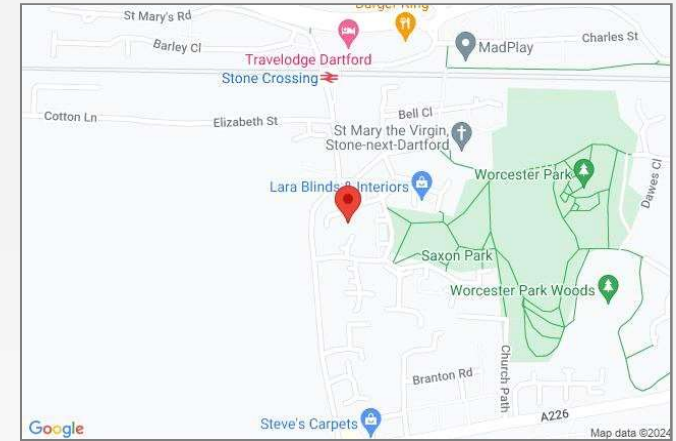

Additional Information

Dartford Borough Council - Tax Band C

Total floor area: 47 sq. metres

Leasehold Information

Time remaining on lease: Approx. 91 years

Ground Rent: £0

Service Charge: £912.42 Per Annum

(All information regarding lease term and service charges have been provided by the seller and should be verified by your solicitor).

FOR MORE INFORMATION
CONTACT US TODAY.

01322 624440

Robinson Jackson
39 High Street,
Swanscombe
Kent,
DA10 0AG

swanscombe@robinson-jackson.com

