



Union Street | Maidstone, Kent, ME14 1EE



Guide Price £220,000 - £240,000

Freehold

**ROBINSON MICHAEL & JACKSON**  
Our service will *move* you

## Union Street, Maidstone

Introducing this delightful two-bedroom home ideally situated in a prime location, just a stone's throw away from the town centre and train station.

### Property Features

- Council Tax: B
- EPC Rating: C
- Two double bedrooms
- No onward chain
- Generous size rear garden
- Situated within close proximity to Maidstone town & mainline train station
- Generous size basement



## Interior

**Lounge** 3.68m x 3.45m (12'1" x 11'4") Walk straight into the lounge, window to the front, open planned dining room

**Dining Room** 3.23m x 4.34m (10'7" x 14'3") Window to the rear, leads into the kitchen, stairs leading up, door leading down to basement

**Kitchen** 3.38m x 2m (11'1" x 6'7") Window to the side, door leading into the garden, space for fridge freezer, washing machine

**Bathroom** 1.85m x 2m (6'1" x 6'7") Window to the side, shower over bath, basin & WC.

Located on the ground floor

**Basement** 4.11m x 3.18m (13'6" x 10'5") Spacious area

**Bedroom 1** 3.56m x 3.45m (11'8" x 11'4") Window to the front, double bedroom

**Bedroom 2** 3.23m x 3.43m (10'7" x 11'3") Window to the rear, built in cupboard, double bedroom

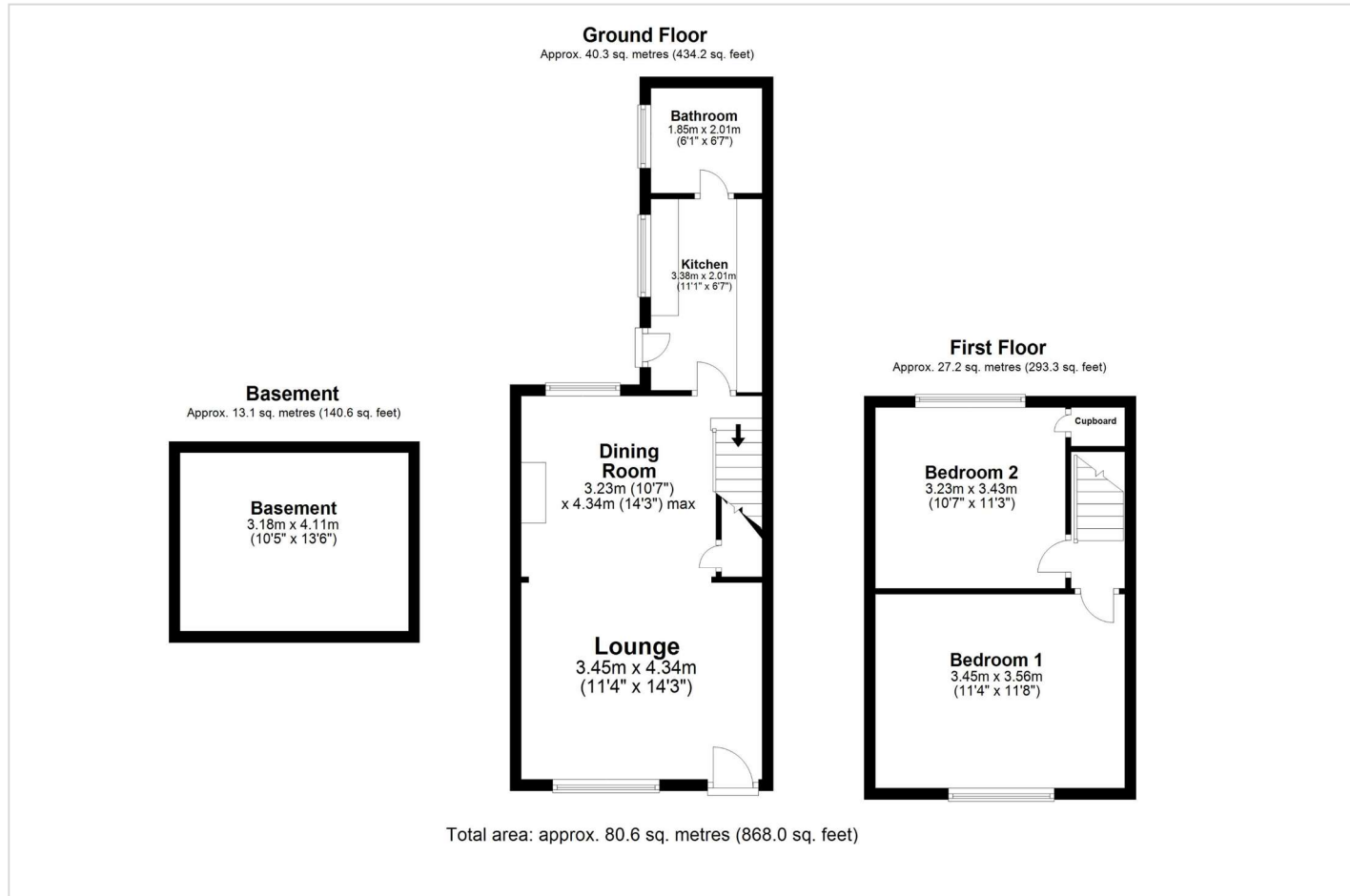



## Property Location

Union Street, Maidstone, Kent, ME14 1EE



    **Scan for the latest properties...** 

Follow us on **facebook** for early access to new properties for sale.



**FOR MORE INFORMATION CONTACT US TODAY.**

01622 476666  
Robinson Michael & Jackson  
15A King Street  
Maidstone,  
Kent ME14 1BA  
maidstone@robinson-jackson.com



These particulars do not form part of an offer or contract and must not be relied upon as statements or representation of fact. Any areas, measurements, journey times or distances are approximate. The text, images, photographs and plans are for guidance only and are not necessarily comprehensive. It should not be assumed that the property has all necessary planning, building regulation or other consents and we have not tested any services, equipment or facilities. References to tenure are based on information supplied by the seller. Buyer should verify all information themselves by inspection or otherwise prior to a legal commitment to purchase. Photos and images are subject to copyright.