



Riverside Road | Sidcup, Kent, DA14 4PU



2/3



2



1

Guide Price £500,000 Freehold

ROBINSON-JACKSON
Our service will *move* you

Riverside Road, Sidcup

Backing onto Foots Cray Meadows is this 2/3 bedroom semi-detached bungalow. Located within walking distance to popular schools and Albany Park Train Station.

Property Features

- Council Tax: E
- EPC Rating: TBC
- 2/3 Bedrooms
- Open Plan Layout
- Ground Floor Shower Room
- First Floor Bathroom
- Utility Room
- Off Street Parking



Interior

Entrance Hall Double glazed entrance door to side, luxury vinyl flooring.

Lounge 5.54m x 3.2m (18'2" x 10'6") Stairs to loft area, feature fireplace, storage cupboard, radiator in decorative cover, luxury vinyl flooring.

Kitchen/Diner 6.7m x 3.05m (22' x 10') Double glazed window to rear, double glazed bi-folding doors to garden, inset spotlights, range of wall and base units, space for cooker, integrated dishwasher and fridge, sink unit with drainer and mixer tap, vertical radiator, part tiled walls, luxury vinyl flooring.

Utility Room 3m x 1.65m (9'10" x 5'5") Double glazed window to side, all and base units, spaces for fridge/freezer, washing machine and tumble dryer, luxury vinyl flooring.

Bedroom One 4.14m x 2.9m (13'7" x 9'6") Double glazed window to front, wardrobes, radiator, carpet.

Bedroom Two Double glazed window to front, radiator, carpet.

Shower Room Double glazed window to side, shower cubicle, wash hand basin set in vanity unit with mixer tap, low level w.c, chrome heated towel rail, tiled walls and flooring.

1st Floor :-

Loft Area 4.78m x 3.2m (15'8" x 10'6") at widest points. Double glazed window to rear, radiator, carpet.

Bathroom Skylight window, wash hand basin set in vanity unit, low level w.c, panelled bath with mixer tap, storage cupboard, tiled walls and flooring.

Exterior

Rear Garden Patio area, astro turf, shrub and tree borders, gate to park.

Front/Driveway The front has been paved to provide off street parking for three vehicles.

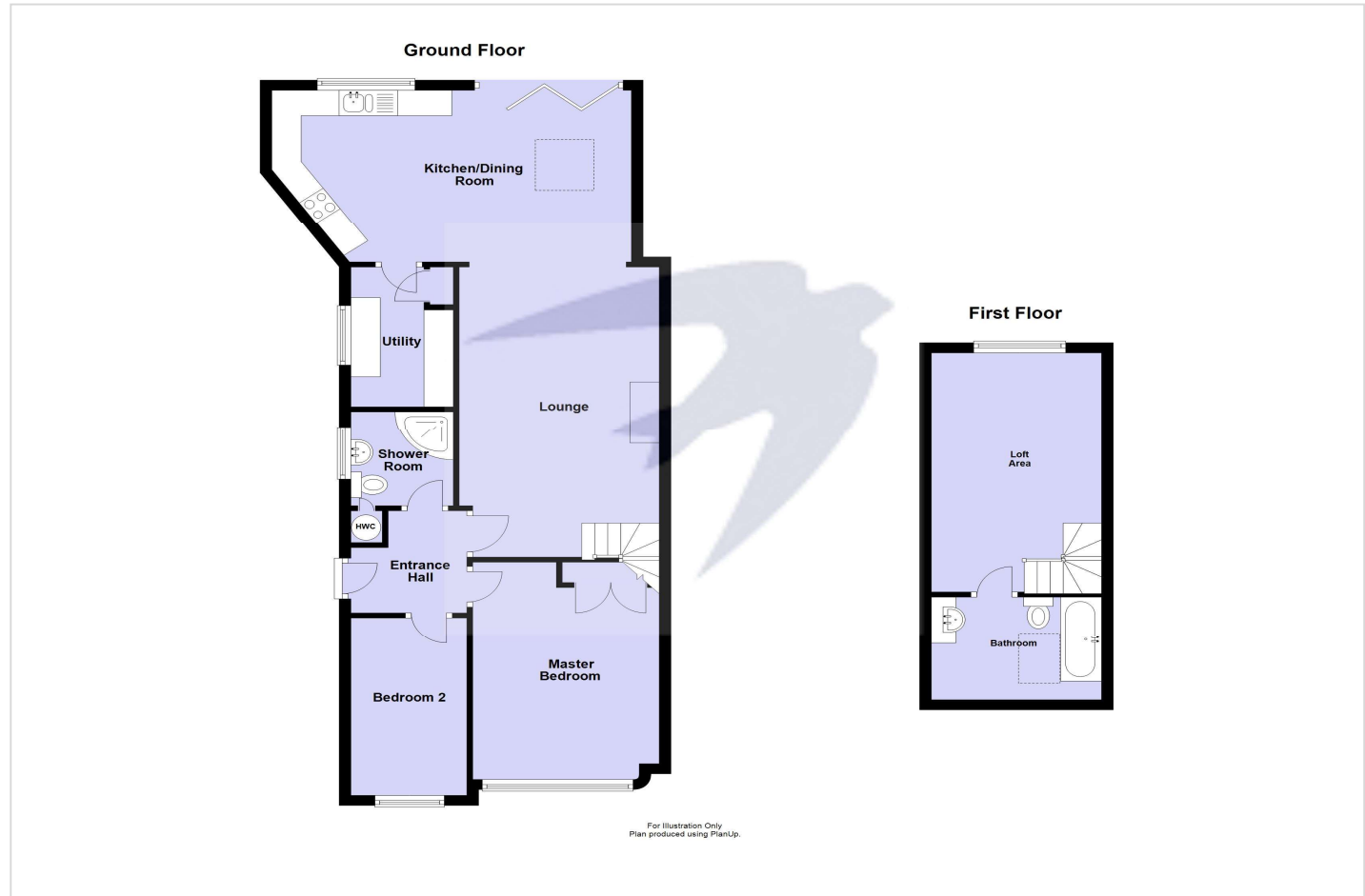



Property Location

Riverside Road, Sidcup, Kent, DA14 4PU



Additional Information

Albany Park is a suburban area located in the London Borough of Bexley. Located midway between Sidcup and Bexley. Both Sidcup and Bexley have their own high street and are brimming with pubs and restaurants, with friendly 'locals' serving the community. Commuters use Albany Park train station for a direct service into Central London, with journey times from 18 minutes. Sidcup and Bexley also have their own train station.



**FOR MORE INFORMATION
CONTACT US TODAY.**

020 8298 0500
Robinson Jackson
1 & 2 Wellington Parade,
Blackfen,
DA15 9NB
tony.murray@robinson-jackson.com



These particulars do not form part of an offer or contract and must not be relied upon as statements or representation of fact. Any areas, measurements, journey times or distances are approximate. The text, images, photographs and plans are for guidance only and are not necessarily comprehensive. It should not be assumed that the property has all necessary planning, building regulation or other consents and we have not tested any services, equipment or facilities. References to tenure are based on information supplied by the seller. Buyer should verify all information themselves by inspection or otherwise prior to a legal commitment to purchase. Photos and images are subject to copyright.