



Hatherley Crescent
Sidcup
DA14 4HY
Leasehold

Spacious one-bedroom GROUND FLOOR retirement property benefiting from a private patio area. Looking out on to well-maintained communal gardens & close to the bustling Sidcup High street & station.

- Chain Free
- Large Lounge/Diner
- Private Patio Area
- Ground Floor
- Shower Room
- Over 55's Only

Guide Price £160,000-£180,000



Council Tax: C
EPC Rating: C

ROBINSON-JACKSON
Our service will *move* you

Ground Floor

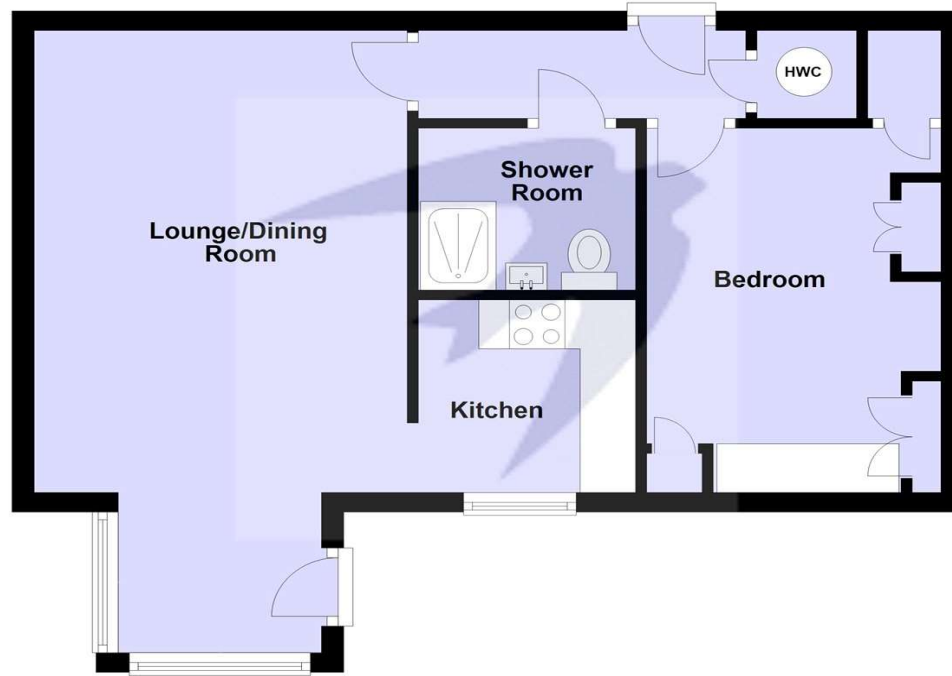

For Illustration Only
Plan produced using PlanUp.

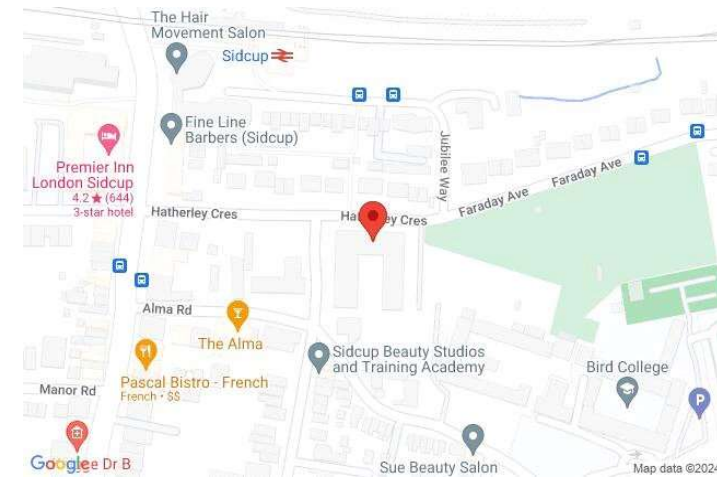

FOR MORE INFORMATION
CONTACT US TODAY.

020 8298 0500
Robinson Jackson
1 & 2 Wellington Parade,
Blackfen,
DA15 9NB
| tony.murray@robinson-jackson.com



Accommodation

Entrance Hall: Storage cupboard, entry phone, wood style laminate flooring.

Lounge: 6.43m x 3.35m (21'1" x 11') Maximum dimensions. Double glazed window to rear, wood style laminate flooring.

Kitchen: 1.98m x 1.96m (6'6" x 6'5") Double glazed window to rear, fitted with a range of wall and base units with complimentary work surfaces, stainless steel sink unit, drainer and mixer tap, integrated hob, vinyl flooring.

Bedroom: 3.76m x 2.64m (12'4" x 8'8") Double glazed window to rear, fitted wardrobes and cupboards, carpet.

Shower Room: Fitted with a three piece suite comprising, shower cubicle, wash hand basin and WC, vinyl flooring.

External: Private patio area and communal gardens.

Leasehold Information

Unexpired term of lease: Approx 62 years

Original start and lease term: 99 years from 24/06/1987

Current ground rent: Peppercorn

Current service charge: Approx £2011.24 per annum

Next ground rent review: TBC

All the above needs to be verified by your solicitor.

Additional Information

Please note as this is a retirement development there is an age restriction where residents need to be 55 years or older.

Sidcup is located in the London Borough of Bexley. It enjoys a busy high street, a library, supermarkets, a train station, the borough's main hospital, good schools and leisure facilities.

Commuters use Sidcup train station for a direct service into Central London, with journey times from 18 minutes. Sidcup is brimming with pubs and restaurants, with friendly 'locals' serving the community.