



Ashleigh Gardens

Blue Bell Hill | Kent | ME5 9GF





Ashleigh Gardens

Blue Bell Hill, Kent, ME5 9GF

£375,000

Freehold

A modern three bedroom town house on a small gated development that must be viewed to appreciate all it offers. Offered to the market with no onward chain

Benefitting from:

- Three bedroom semi detached town house
- Two allocated parking bays
- Three double bedrooms
- Ensuite & Ground floor WC
- Modern fitted kitchen with appliances
- NO chain
- Council Tax: D
- EPC Rating: C



Accommodation

Ground Floor

Entrance Hall

Kitchen 4.45m x 2.13m (14'7" x 7')

Lounge Diner 5.54m x 4.32m (18'2" x 14'2")

Ground floor WC

First Floor

Bedroom Two 4.3m x 3.15m (14'1" x 10'4")

Bedroom Three 4.32m x 2.7m (14'2" x 8'10")

Family Bathroom 2.87m x 1.88m (9'5" x 6'2")

Second Floor

Master Bedroom 4.83m x 3.15m (15'10" x 10'4")

Ensuite 2.8m x 2.29m (9'2" x 7'6")

Exterior

Flat rear garden

Artificial grass

Easy maintenance

secure fencing

Side access





Council Tax - D

EPC Rating - C





Important Notice

These particulars do not form part of an offer or contract and must not be relied upon as statements or representation of fact. Any areas, measurements, journey times or distances are approximate. The text, images, photographs and plans are for guidance only and are not necessarily comprehensive. It should not be assumed that the property has all necessary planning, building regulation or other consents and we have not tested any services, equipment or facilities. References to tenure are based on information supplied by the seller. Buyer should verify all information themselves by inspection or otherwise prior to a legal commitment to purchase. Photos and images are subject to copyright.

Location



(All distances & times are approximates)

FOR MORE INFORMATION CONTACT US TODAY.

Kendell Laretive - Assistant Manager

01634 868000

Robinson Michael & Jackson
381 Walderslade Road,
Walderslade,
Kent ME5 9LL

walderslade@robinson-jackson.com

SALES | MORTGAGES | LEGALS

ROBINSON MICHAEL & JACKSON



Ground Floor
Area: 44.6 m² ... 480 ft²

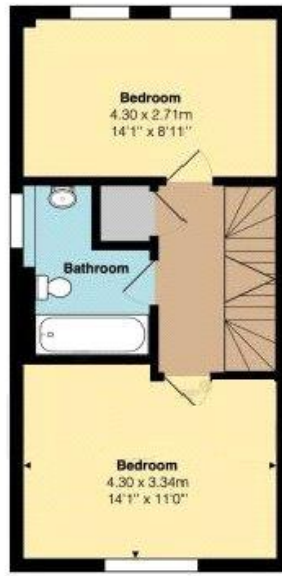

First Floor
Area: 40.0 m² ... 430 ft²



Second Floor
Area: 33.8 m² ... 364 ft²

Total Area: 118.4 m² ... 1274 ft²

