



Windmill Street | Kent, ME2 3XL



Guide Price £300,000 to £325,000 Freehold

ROBINSON MICHAEL & JACKSON
Our service will *move* you

Windmill Street,

Guide Price £300,000-£325,000

Robinson Michael & Jackson are proud to present this three bedroom home. Which is being offered to the market with no onward chain and driveway for multiple vehicles.

Property Features

- Council Tax: B
- EPC Rating: D
- 947 square feet
- No chain
- Three bedrooms
- Driveway for multiple cars
- Walking distance to local amenities
- Sizeable rear garden



Interior

Lounge 4.6m x 5.77m (15'1" x 18'11") Carpet, double glazed window to front, gas fire, double glazed French doors to rear, radiator x two.

Kitchen 2.36m x 5.94m (7'9" x 19'6") Vinyl flooring, space for appliances, double glazed window to front, wall to base units with roll over work surface, boiler, sink with mixer tap, radiator.

Bedroom One 4.04m x 3.43m (13'3" x 11'3") Carpet, double glazed window to front, fitted wardrobes, storage cupboard, radiator.

Bedroom Two 4.01m x 3.28m (13'2" x 10'9") Carpet, double glazed window to front, radiator.

Bedroom Three 2.62m x 2.34m (8'7" x 7'8") Carpet, radiator, double glazed window to rear.

Bathroom 2.13m x 1.83m (7' x 6') Tiled floor to ceiling, towel rail, sink basin with mixer tap, panelled bath with shower over, double glazed window to rear.

W/C 1.6m x 0.8m (5'3" x 2'7") Vinyl flooring, double glazed window to rear, low level w.c.

Exterior

Rear garden Shed with power & water supply, lawn & patio area.

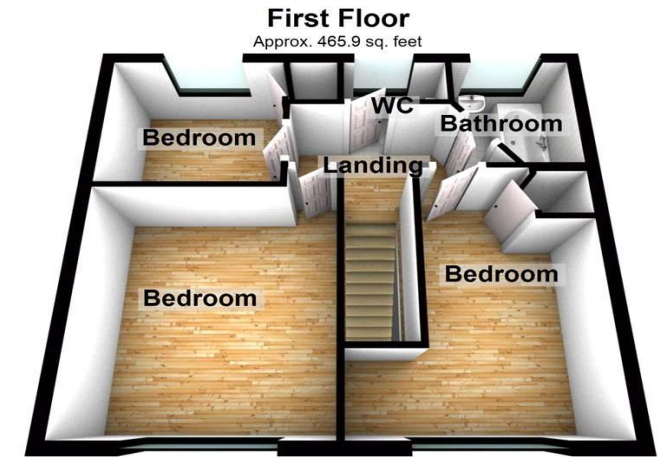
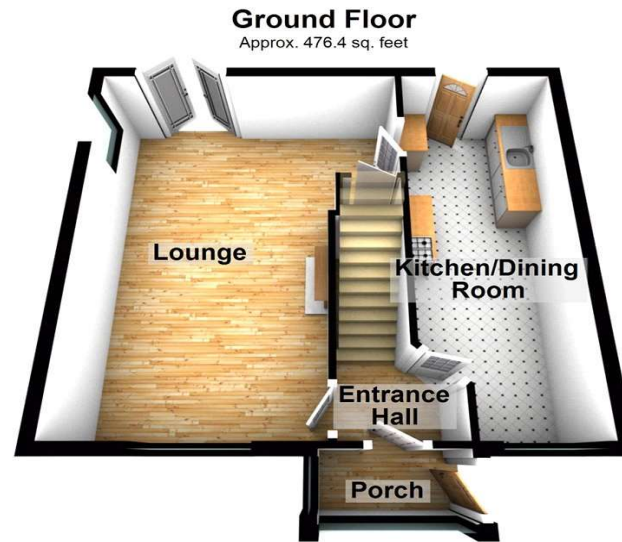

Total area: approx. 942.3 sq. feet

Please be advised this plan is offered for marketing purposes only. It can not be relied upon for exact or precise measurements, angles, window or door openings. Whilst every effort is made to ensure the accuracy the company or provider accepts no responsibility for the content.
Plan produced using PlanUp.





Property Location

Windmill Street, Kent, ME2 3XL

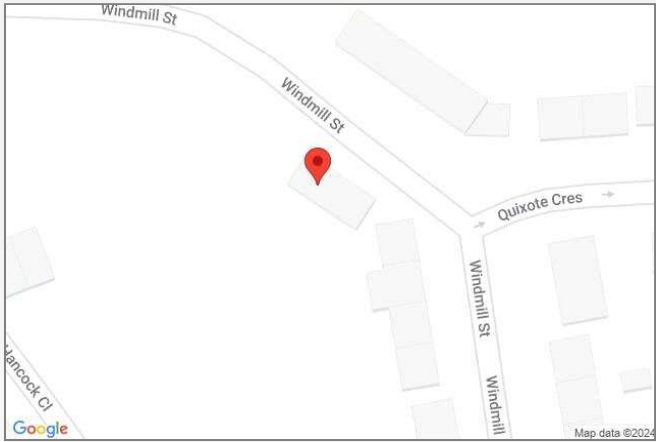

 Scan for the latest properties... 

Follow us on **facebook** for early access to new properties for sale.



Additional Information

Frindsbury, sometimes called Frinsbury, is part of the Medway in Kent, southern England. It lies on the opposite side of the River Medway to Rochester, and at various times in its history has been considered fully or partially part of the City of Rochester. There are a row of shops opposite a Tesco garage which include a barbers, chip shop and newsagents. Within walking distance from these shops is a local Catholic church, primary schools which do include Hilltop Primary school.

Key facts for buyers



FOR MORE INFORMATION CONTACT US TODAY.

01634 722777
Robinson Michael & Jackson
109 High Street
Strood,
Kent ME2 4TJ
strood@robinson-jackson.com



These particulars do not form part of an offer or contract and must not be relied upon as statements or representation of fact. Any areas, measurements, journey times or distances are approximate. The text, images, photographs and plans are for guidance only and are not necessarily comprehensive. It should not be assumed that the property has all necessary planning, building regulation or other consents and we have not tested any services, equipment or facilities. References to tenure are based on information supplied by the seller. Buyer should verify all information themselves by inspection or otherwise prior to a legal commitment to purchase. Photos and images are subject to copyright.