



WARNING
Obstruction of Footway

Talehangers Close | Bexleyheath, Kent, DA6 8AE



£295,000 to £300,000

Leasehold



Talehangers Close, Bexleyheath

Situated in a popular development on the Southside of Bexleyheath within access to Danson Park and Bexleyheath mainline station is this two-bedroom dual-aspect first floor apartment.

Property Features

- Council Tax: D
- EPC Rating: C
- Two bedrooms- Two Bathrooms
- Open plan living
- En Suite
- Allocated Parking
- Balcony
- Close to public transport



Interior

Hallway

Kitchen/Living Room 5.6m x 5.56m (18'4" x 18'3")

Bedroom 1 4.06m x 3.02m (13'4" x 9'11")

Ensuite 1.9m x 1.5m (6'3" x 4'11")

Bedroom 2 2.95m x 2.67m (9'8" x 8'9")

Bathroom 2.64m x 1.6m (8'8" x 5'3")

Balcony

Exterior

- **Balcony**
- **Julliet Balcony**
- **Allocated Parking Space**

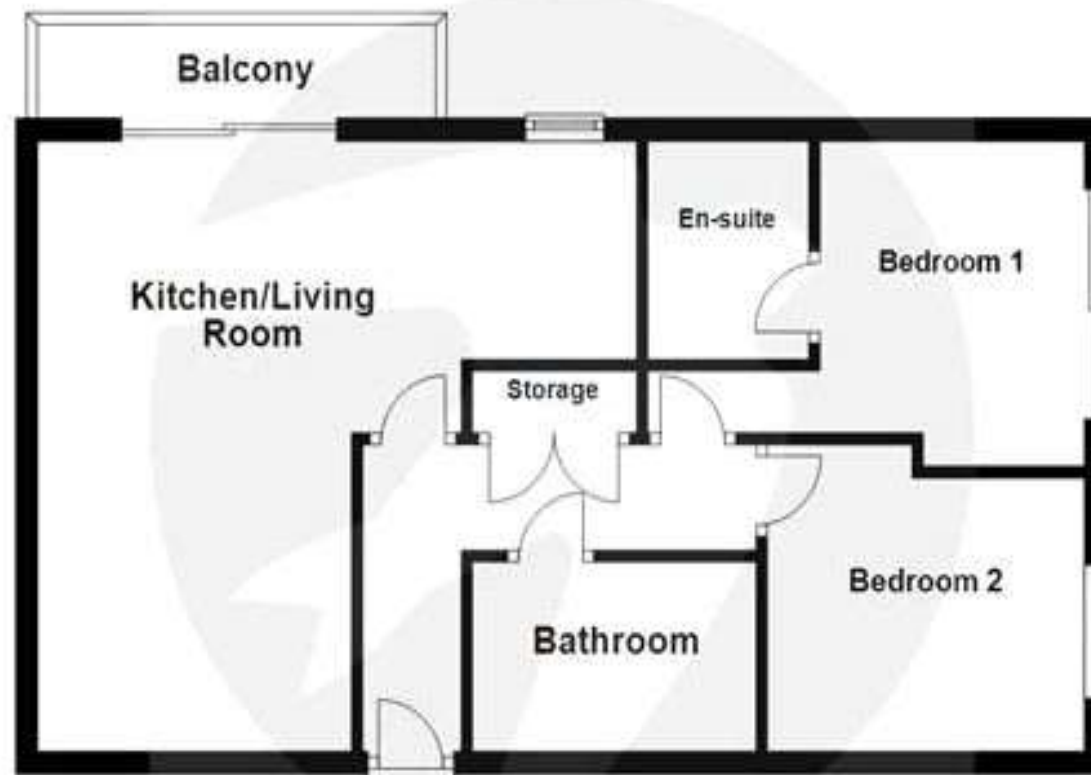



Property Location

Talehangers Close, Bexleyheath, Kent, DA6 8AE

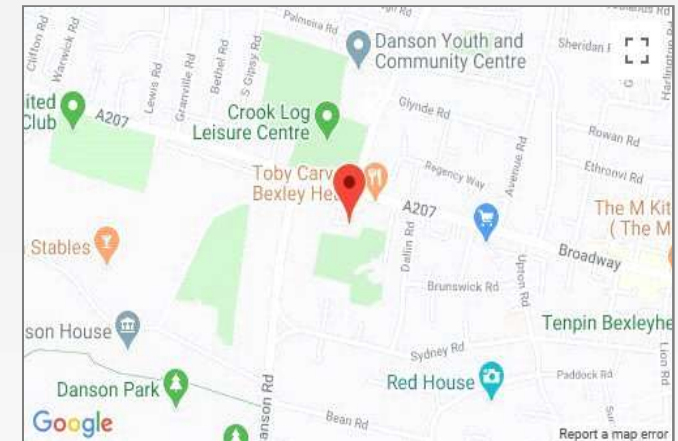

Additional Information

Bexleyheath is home to the borough's largest shopping facility, where you'll find high-street names, and supermarkets. There's a bowling alley, a cinema, Crook Log Leisure Centre, regular specialist markets and family-friendly restaurants too.

Families are also attracted to Bexleyheath for the schooling – with two of the borough's grammars and excellent primaries close by. The Red House – an Arts & Crafts property designed for the artist and socialist William Morris - is Bexleyheath's premier cultural attraction.

FOR MORE INFORMATION CONTACT US TODAY.

020 8298 7000

Robinson Jackson
124 Broadway,
Bexleyheath,
Kent DA6 7DQ

bexleyheath@robinson-jackson.com

