



Gordon Road | Northfleet, Kent, DA11 9JW



Asking Price £290,000

Freehold

ROBINSON MICHAEL & JACKSON

Our service will *move* you

Gordon Road, Northfleet

Introducing this gorgeous three-bedroom terraced property in sought after Northfleet. With three great sized bedrooms and immaculately presented throughout, this is not one to miss!

Property Features

- Total Square Footage: 820.2 Sq. Ft.
- Council Tax: B
- EPC Rating: D
- Three Double Bedrooms
- Immaculate Condition Throughout
- Sun Trap Garden
- Open Plan Living Space
- Perfect Family Living
- Modern Kitchen



Interior

Entrance Hall: 4.04m x 0.74m (13'3" x 2'5") Entrance door into hallway. Wood flooring. Radiator. Doors to: _

Lounge Diner: 7.52m x 3.15m (24'8" x 10'4") Double glazed window to front. Double glazed door to garden. Feature log burner. Wood flooring. Open plan.

Kitchen: 3.2m x 2.72m (10'6" x 8'11") Double glazed window to side. Wall and base units with roll top work surface over. Two integrated ovens, microwave & hob with extractor hood over. Free standing fridge freezer and dishwasher. Sink and drainer unit.

First Floor Landing: Stairs to first floor. Doors to: -

Bedroom 1: 4m x 3.45m (13'1" x 11'4") Double glazed window to front x 2. Two radiators. Feature fireplace. Carpet.

Bedroom 2: 3.3m x 2.46m (10'10" x 8'1") Double glazed window to rear. Radiator. Carpet.

Bedroom 3: 3.2m x 2.6m (10'6" x 8'6") Double glazed window to rear. Fireplace (boarded up). Radiator. Carpet.

Bathroom 2.41m x 1.75m (7'11" x 5'9") Double glazed frosted window to side. Suite comprising bath with shower over. Wash hand basin. Low level w.c. heated towel rail. Built-in cupboard. Tiled walls. Tiled flooring.

Exterior

Rear Garden: 24'4 x 13'9: Paved garden. Fence enclosed. Rear pedestrian access.

Parking: On street parking.

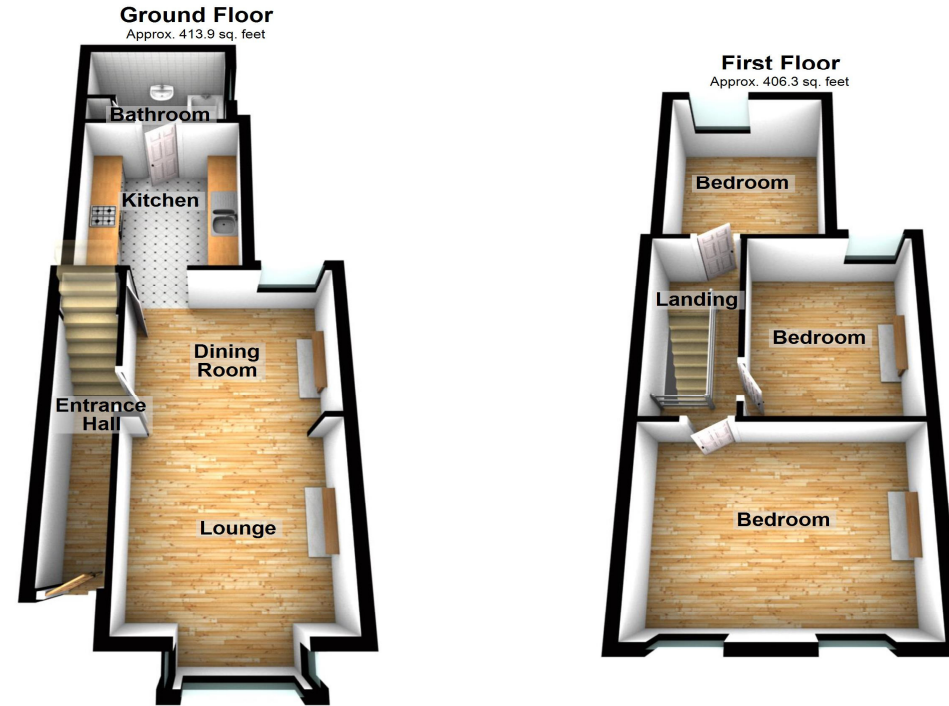

Total area: approx. 820.2 sq. feet

Please be advised this plan is offered for marketing purposes only. It can not be relied upon for exact or precise measurements, angles, window or door openings. Whilst every effort is made to ensure the accuracy the company or provider accepts no responsibility for the content. Plan produced using PlanUp.





Property Location

Gordon Road, Northfleet, Kent, DA11 9JW

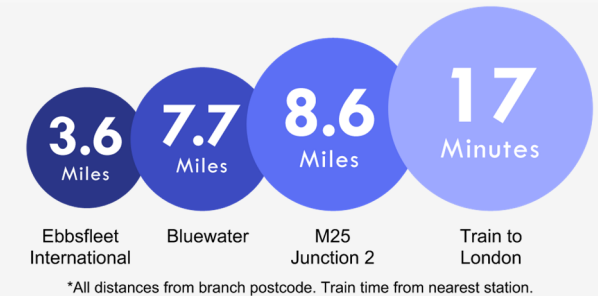
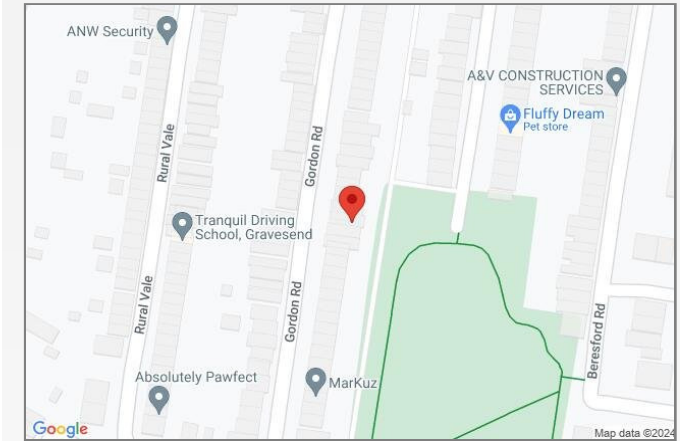

Additional Information

With families flocking to Northfleet and Gravesend for excellent education, the town has some great facilities to match including: - Cascades Leisure Centre and the Cygnets Leisure Centre both for swimming, gym, classes and fitness training. There are numerous clubs and team sports throughout Northfleet & Gravesend including Ebbsfleet United Football Club, Gravesend Rugby Club and Gravesend Golf Centre.

**FOR MORE INFORMATION
CONTACT US TODAY.**

01474 333111

Robinson Michael & Jackson
21A & B King Street,
Gravesend,
DA12 2EB

gravesend@robinson-jackson.com

