



Riverhead Close | Sittingbourne, ME10 1UZ



Guide Price £325,000 to £350,000 Freehold

ROBINSON MICHAEL & JACKSON
Our service will *move* you

Riverhead Close, Sittingbourne

Situated in the desirable Riverhead Close, this impressive three-bedroom semi-detached property offers spacious and modern living accommodation.

Upon entering the property, you are greeted by a welcoming lounge, perfect for relaxation or entertaining guests. The ground floor also boasts an open-plan kitchen diner, providing ample space for dining and meal preparation. The modern kitchen is well-equipped, making it the heart of the home and ideal for families.

Upstairs, you will find three good-sized bedrooms, offering comfortable accommodation for families or individuals. Additionally, there is a well-appointed family bathroom, complete with modern fixtures and fittings.

Externally, the property benefits from both front and rear gardens, providing outdoor space for relaxation and enjoyment. Furthermore, the property features a garage and driveway, offering off-street parking and additional storage space.

Located in the sought-after Riverhead Close, this property is ideally situated close to local amenities, schools, and transport links. With its spacious accommodation, modern features, and convenient location, this property is perfect for families looking for their next home.



Property Features

- Council Tax: D
- EPC Rating: C
- Three bedroom semi detached
- Garage & driveway
- Fully renovated
- No chain
- Open plan kitchen/diner
- Sought after location

Interior

Entrance Hall:

Lounge: 3.96m x 3.12m (13' x 10'3")

Dining Room 3.3m x 2.82m (10'10" x 9'3")

Kitchen: 3.3m x 2.16m (10'10" x 7'1")

Bedroom One: 3.96m x 3.12m (13' x 10'3")

Bedroom Two: 3.3m x 3.12m (10'10" x 10'3")

Bedroom Three: 3.05m x 1.88m (10' x 6'2")

Bathroom: 2.13m x 1.85m (7' x 6'1")

Exterior

Front and rear gardens

Garage & driveway

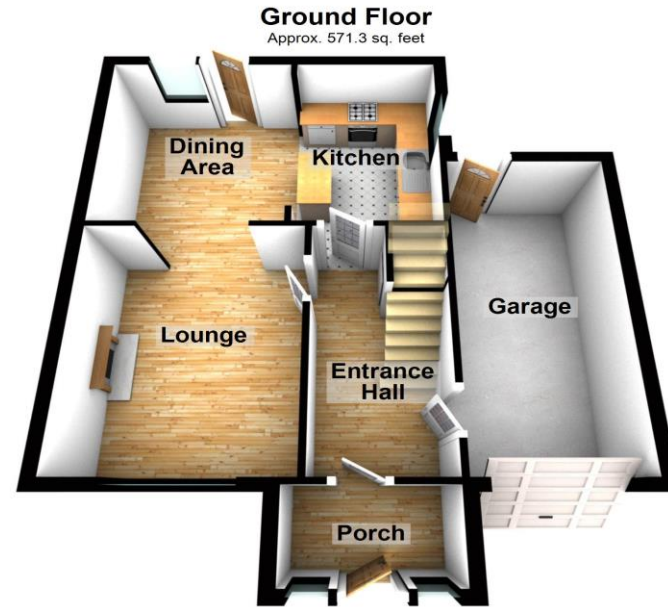

Total area: approx. 977.2 sq. feet

Please be advised this plan is offered for marketing purposes only. It can not be relied upon for exact or precise measurements, angles, window or door openings. Whilst every effort is made to ensure the accuracy the company or provider accepts no responsibility for the content.

Plan produced using PlanUp.





Property Location

Riverhead Close, Sittingbourne, ME10 1UZ

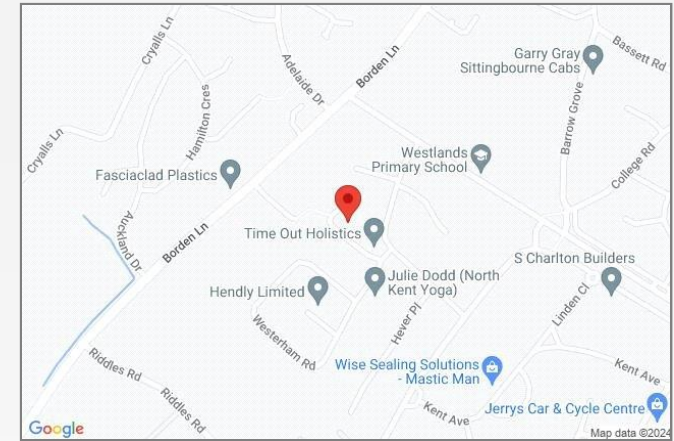

**FOR MORE INFORMATION
CONTACT US TODAY.**

01795 479999
Robinson Michael & Jackson
38 West Street,
Sittingbourne,
Kent, ME10 1AP
sittingbourne@robinson-jackson.com

